

Wandmontage / Wall mount

Vorderansicht/
Front view

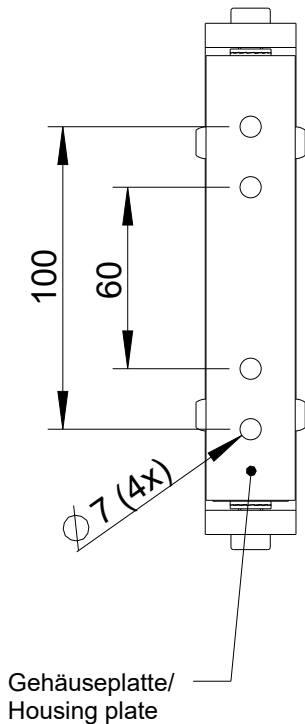

Seitenansicht/
Side view

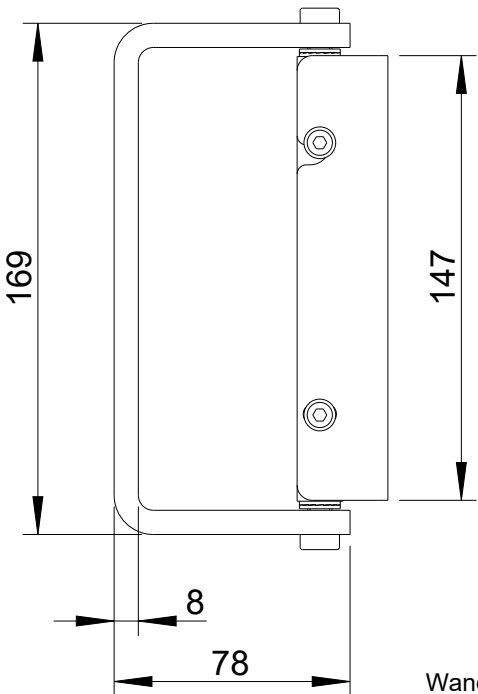

Rückansicht/
Rear view

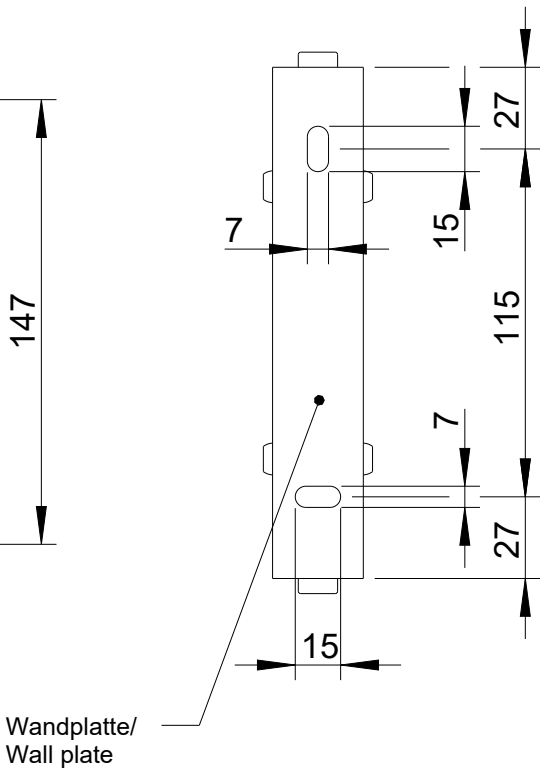

Draufsicht/
Top view

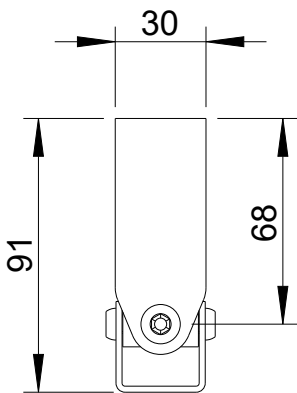

Drehung +/-90°/
Rotation +/-90°

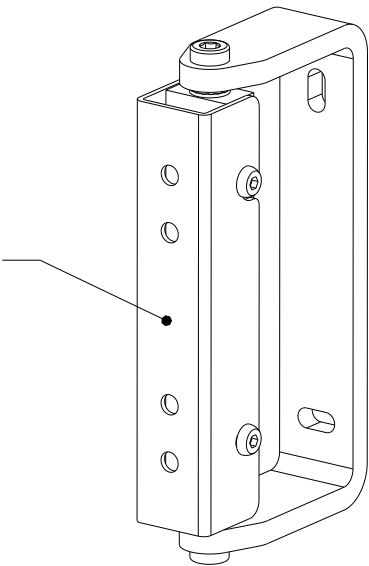

All data and dimensions are subject to change

WLF-2
8438-xxxxx

All data and dimensions are subject to change

< Produktbezeichnung >
< 1234-xxxxx (Artikelnummer) >