



Fohhn

2D drawings

Linea

LS-4

Vorderansicht/
Front view



Seitenansicht/
Side view



Rückansicht/
Rear view

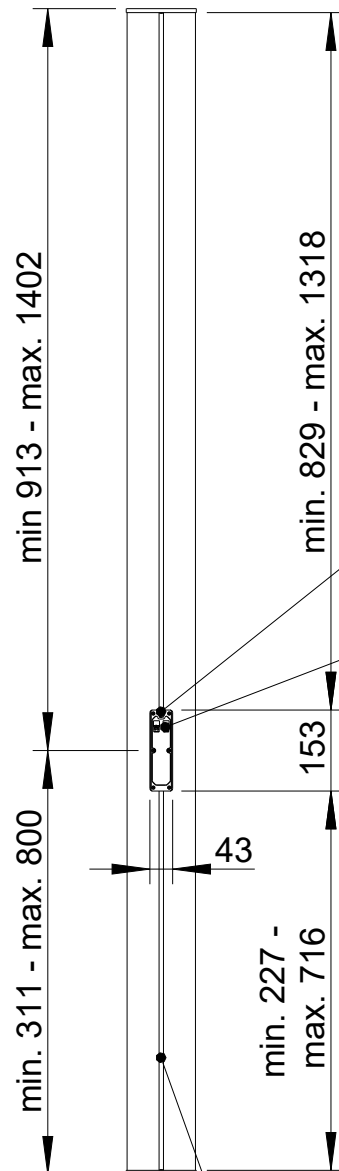

Zugentlastung/
Cable relief

Anschlussterminal
2x 2-Pol Klemme
für Input 1 und Input 2
(2-Kanal-Betrieb möglich)/
Speaker terminal
2x 2-pin connector
for input 1 and input 2
(bi-amping possible)

Fohhn Logo, drehbar
in 90° Schritten/
Fohhn-logo rotatable
in steps of 90°

Stahlgitter, mit
Akustikschaum hinterlegt/
Steel grille, backed by
acoustically transparent foam

T-Nut für
Nutensteine M6/
T-slot for
slot nuts M6

Draufsicht/
Top view

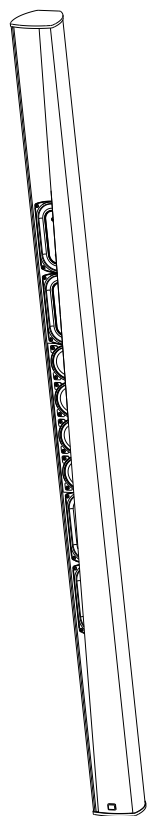
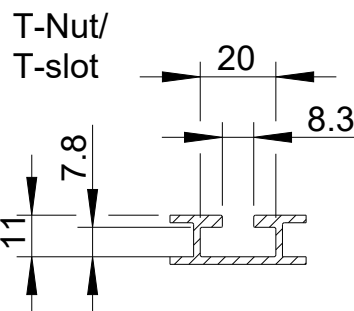
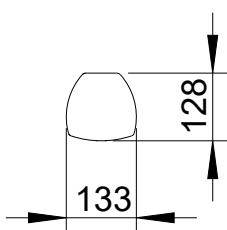

All data and dimensions are subject to change

LS-4S
4404-xxxxx

Vorderansicht/
Front view

Seitenansicht/
Side view

Rückansicht/
Rear view

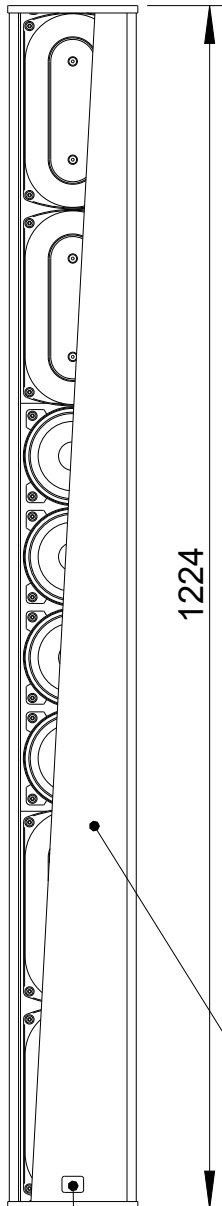

Fohhn Logo, drehbar
in 90° Schritten/
Fohhn-logo rotatable
in steps of 90°

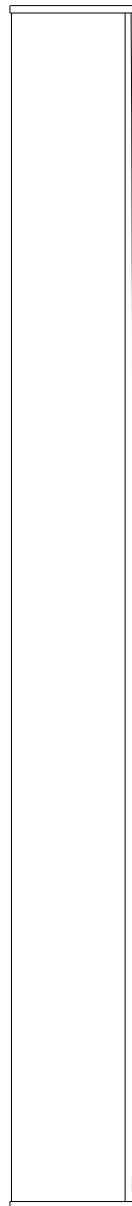

Stahlgitter, mit
Akustikschaum hinterlegt/
Steel grille, backed by
acoustically transparent foam

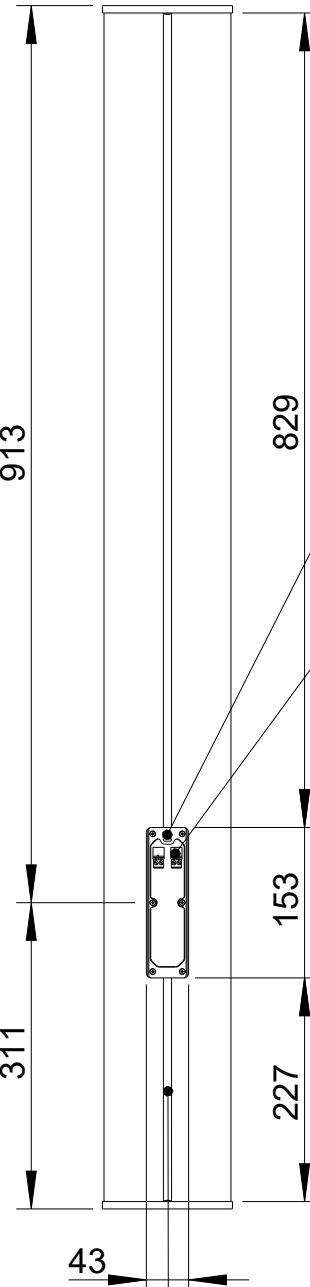

Zugentlastung/
Cable relief

Anschlussterminal
2x 2-Pol Klemme
für Input 1 und Input 2
(2-Kanal-Betrieb möglich)/
Speaker terminal
2x 2-pin connector
for input 1 and input 2
(bi-amping possible)

T-Nut für
Nutensteine M6/
T-slot for
slot nuts M6

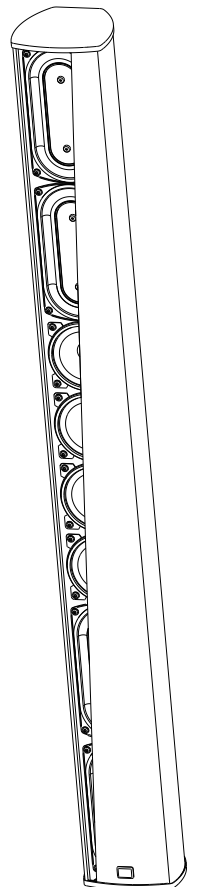

Draufsicht/
Top view

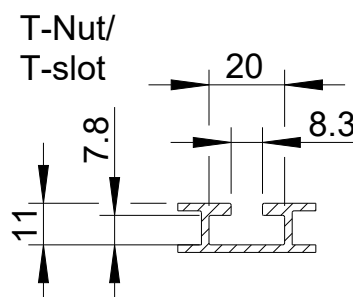
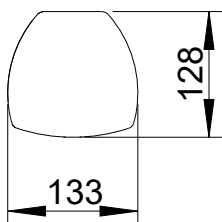

All data and dimensions are subject to change

LS-4
4403-xxxxx

Fohhn Audio AG
Großer Forst 15
72622 Nuertingen
Germany

Phone +49 7022 93323-0
Fax +49 7022 93324-0
www.fohhn.com
info@fohhn.com

