



**100%  
ELEGANCE**

# LINEA LX-220

## PEAK PERFORMANCE POWER.

**Linea LX-220 is an extremely high performance, hybrid line source system incorporating state-of-the-art 4-way speaker technology.**

It combines innovative line array technology with elegant design. The system was specially developed to provide the best possible sound quality for speech and live music applications in challenging acoustic environments, as well as enabling effective integration into architectural surroundings.

18 x 4" high performance speakers arranged in a column, plus three 1" compression drivers with horn loaded Fohhn Waveguide system, produce a very direct, cylindrical beam characteristic. At the heart of these cylindrical waveforms, the sound pressure level remains much more constant over distance compared with conventional loudspeakers. This has a very positive effect on the overall sound coverage. What's more, the sound reaches the audience more directly than with other conventional systems. Unwanted reflections from the ceiling or floor can be avoided, which greatly improves speech intelligibility especially in reverberant rooms. Using the LX-220, complex microphone set-ups can also be quickly and easily implemented. The inclusion of high quality aluminium housing and laminated speakers enables the unit to be used outside. For live applications, the LX-220 can be combined with Fohhn AS-20, AS-30, AS-40 or XS-20, XS-30 and XS-4 subwoofers.

Recommended amplifiers for the LX-220:  
Fohhn D-2.1500 or D-4.1200 DSP-controlled systems.

## THE MAIN FACTS AT A GLANCE

- High performance 4-way hybrid line source/mini line array system
- Long reach and excellent speech intelligibility
- State-of-the-art loudspeaker technology: 18x4" neodymium long excursion chassis and 3x1" compression drivers with specially developed waveform
- Sophisticated multi-zone crossover points with electronic IPC high frequency protection
- Excellent sound quality for both speech and live music
- Very even, controlled sound coverage with high resistance to feedback
- Weatherproof aluminium housing
- Elegant design, perfect integration into room architecture

## APPLICATIONS

→ Ideal for fixed installation in churches, cathedrals, universities, conference rooms, halls etc.

# A PERFECT COMBINATION OF POWER AND ELEGANCE.

Customers who have successfully used Linea LX-100 and LX-150 systems in various projects told us they wished we had a high performance hybrid line array system capable of covering larger sized rooms – approx. 35 m in length. Intensive development work and a 2.2m loudspeaker length has now turned that wish into a reality.



# LINEA LX-220

HIGH-PERFORMANCE HYBRID LINE ARRAY SYSTEM.

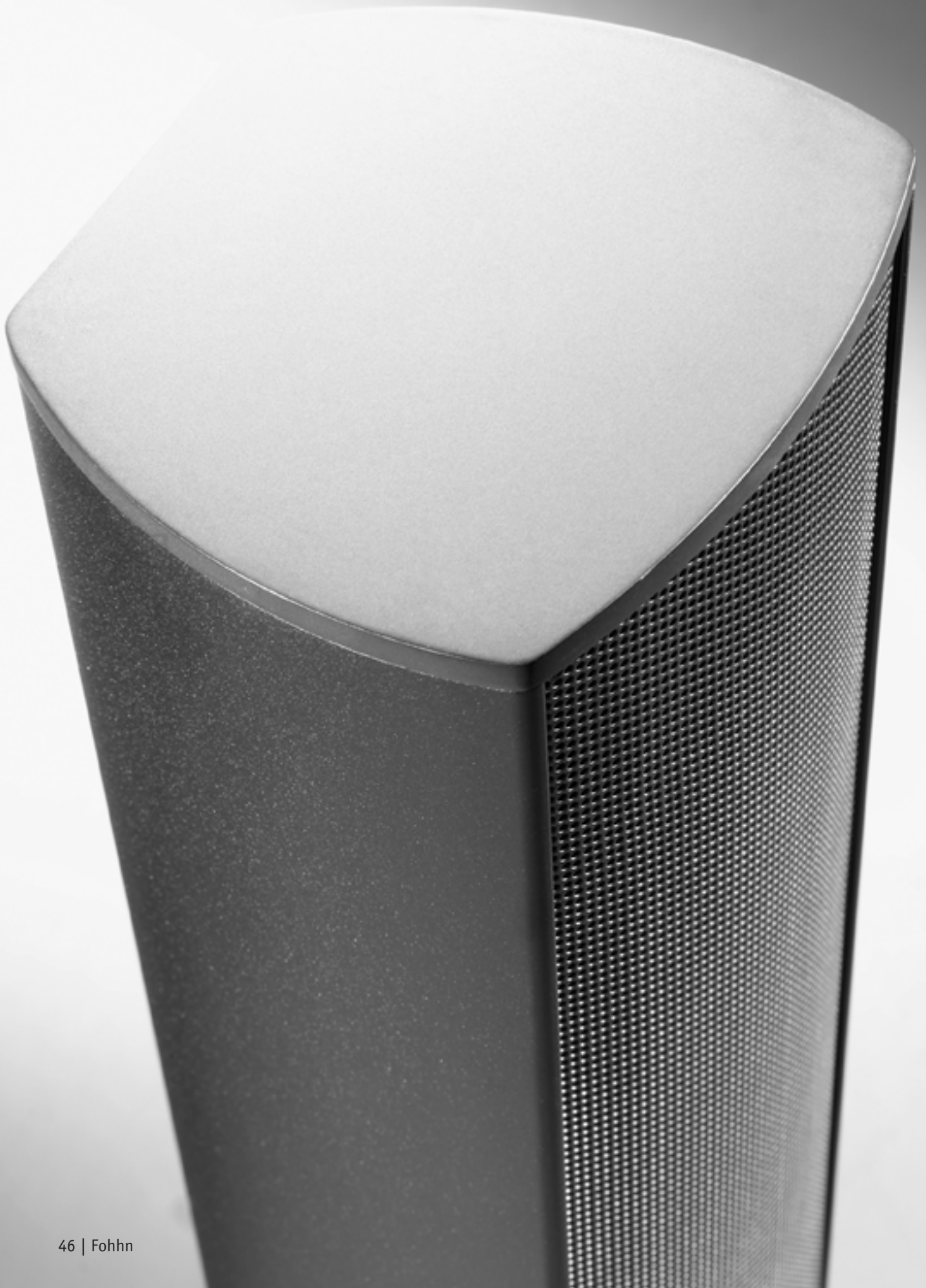

## LINEA LX-220

Front View

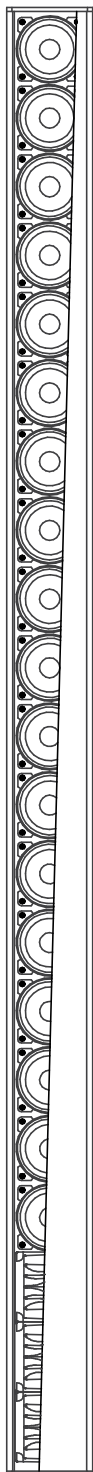

Side View

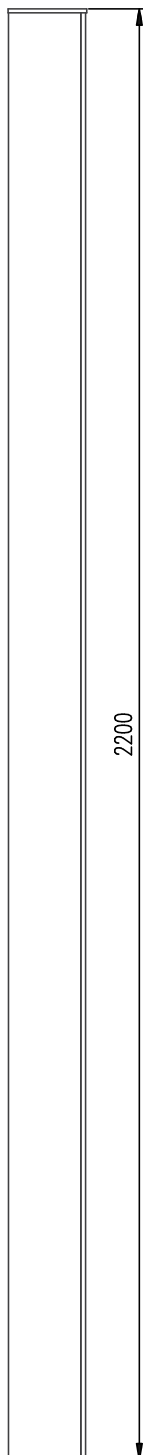

Top View

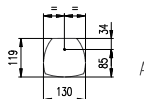

### Electro-acoustical features

Acoustic design	passive hybrid line source speaker system, 4-way, weather resistant
Components <sup>[*]</sup>	18x 4" long excursion with treated cones, 3x 1" compression driver on Fohhn®-Waveguide with self-resetting IPC[*]-HF protection, fully neodymium
Power rating (nominal) <sup>[1]</sup>	900 W
Power rating (programm) <sup>[2]</sup>	1800 W
Power rating (peak) <sup>[3]</sup>	3600 W
Sensitivity <sup>[4]</sup>	96 dB
Maximum SPL <sup>[3]</sup>	131 dB
Frequency range <sup>[5]</sup>	65 Hz – 20 kHz
Nominal dispersion (h x v) <sup>[6]</sup>	130°x15°
Nominal impedance	40hm

### Features

Enclosure	Weatherproof aluminum
Protection grille	steel, ball impact resistant, powder coated
Rigging points	12x M6 threads
Connections	8-pin Phoenix terminal
Standard colours	black or white powder coated
Front design	steel grille in enclosure colour, backed by acoustically transparent foam
Dimensions (w x h x d)	130 x 2200 x 120 mm
Weight <sup>[7]</sup>	16 kg

### Optional features

Integrated 100V-transformer	60/30/15 W
Special colours	all RAL colours
Weather protection	weatherproof

CAAD simulation data	EASE
----------------------	------

The manufacturer reserves the right to make technical modifications according to legal regulations stipulating the continual improvement of product features. [1] according to IEC-60268-5 long term [5] -10 dB under anechoic halfspace-conditions, [2] according to IEC-60268-5 short term, [6] horizontal x vertical at -6 dB, averaged 1-4 kHz, [3] Peak, 20 ms with bandpass filtered pink noise signal according to IEC 60268-2 at one octave above the lower limit of the frequency range. [7] net weight without optional equipment, [4] 2,83 V at 8 ohms (2 V at 4 ohms, 4 V at 16 ohms) at a distance of 1 metre under anechoic fullspace conditions, [\*] Intelligent Protection Circuit. Voltage-controlled semiconductor circuit protecting the HF-driver against overload highly effective and with very short attack time.

SOUNDS PERFECT. IS PERFECT.



FOHNN® AWARDS.



LES ETOILES DU SIEL  
für Focus Modular

## OUR LOVE OF DETAIL GOES FAR BEYOND THIS BROCHURE:

On our website you can find detailed product descriptions, technical data, accessories and full data sheets for download, along with 360° product views, user guides, PDF brochures, CAD drawings, 2D and 3D DWG files, Fohhn software, firmware updates, EASE and ULYSSES simulation data, references and much more.

Visit us at [www.fohhn.com](http://www.fohhn.com)



German quality  
engineered and made  
by Fohhn®

**Fohhn Audio AG**  
Hohes Gestade 3-7  
72622 Nürtingen  
Germany  
Tel. +49 7022 93323-0  
Fax +49 7022 93324-0  
[www.fohhn.com](http://www.fohhn.com)  
[info@fohhn.com](mailto:info@fohhn.com)