

Assembly guide WS-2 (8461-xxxxx)

1.

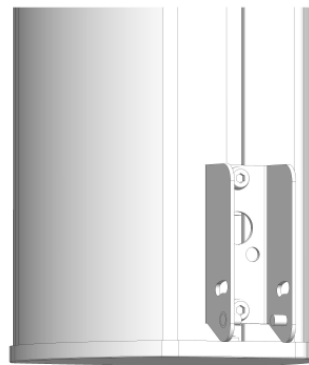

2.



Vertical speaker position: WS-2 housing plate may be positioned anywhere at the length of the cabinet. The slot nuts are supplied with the speaker.

(1.)

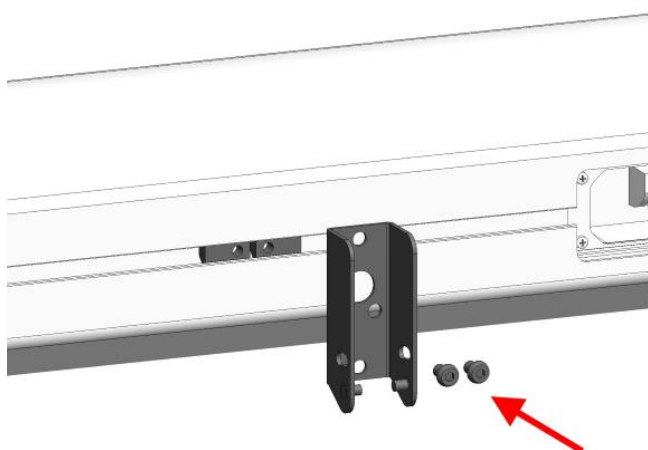

(2.)

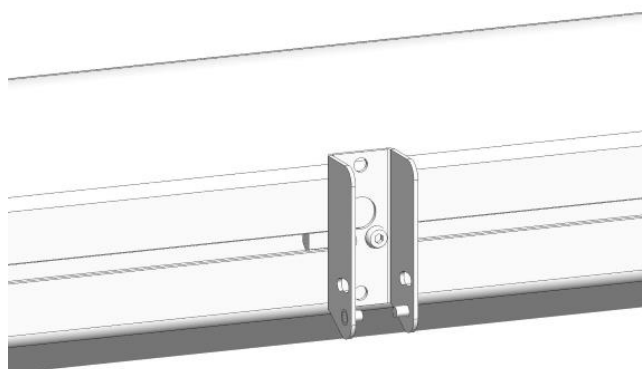

Horizontal speaker position: WS-2 housing plate should be positioned at the centre of gravity of the cabinet. For speaker longer than 1,3 m we recommend to use two WS-2 at a distance instead of one at the centre.

3.

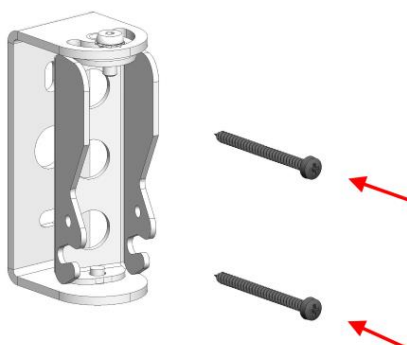

Mount the wall part of the WS-2 to the wall. Make sure all screws and dowels as well as the wall itself are suitable to carry the weight of the speaker. (Screw diameter max. 5 mm)

4.

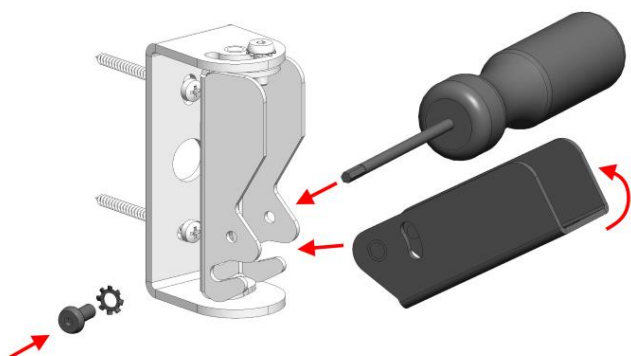

Guide the bolts of the housing plate into the hinge-slots of the wall part. If suitable, you may insert e.g. a screwdriver into one of the threaded holes to join the two parts temporarily. (Picture shown without speaker)

5.

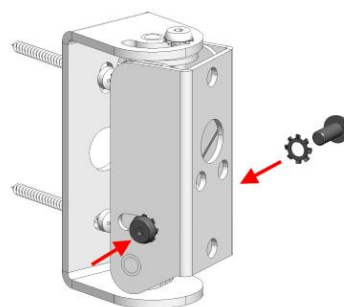

Assemble the parts with a tooth lock washer and an Allen bolt on each side. (Picture shown without speaker)

6.

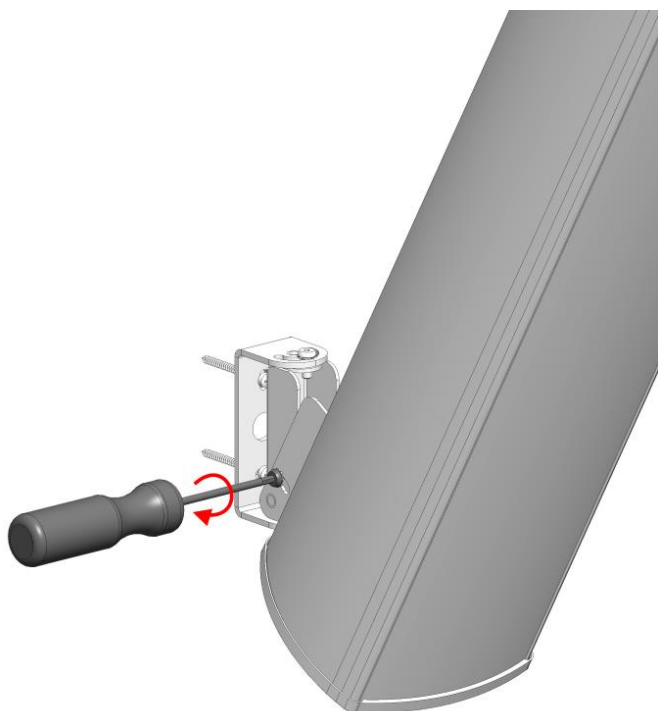

To adjust the vertical orientation of the speaker, loosen the bolts on both sides of the WS-2, tilt the speaker as desired and tighten the bolts again.

7.

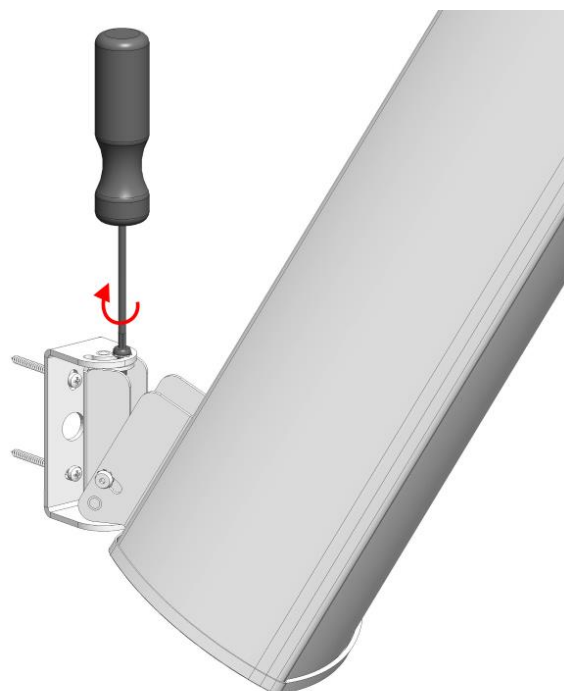

To adjust the horizontal orientation of the speaker, loosen the bolt on top of the WS-2, rotate the speaker as desired and tighten the bolt again.